

H2SD

Honda CB600F Hornet 1998-2006 Honda CBF600(S) 2004-2007

Kit for left side:

ID	Description	Cat.N	Qt
1	Dural.bracket for SLD	537	1
2	Bolt M8x25	815	2
3	Washer M8	800	2
4	Dural. spacer d=40mm	12	1
5	Bolt M10x120	881	1
6	Washer M10	804	1
7	Nut M10	810	1

Kit for right side:

ID	Description	Cat.N	Qt
1	Dural.bracket for SLD	537	1
2	Bolt M8x25	815	2
3	Washer M8	800	2
4	Dural. spacer d=15mm	9	1
5	Bolt M10x90	880	1
6	Washer M10	804	1
7	Nut M10	810	1

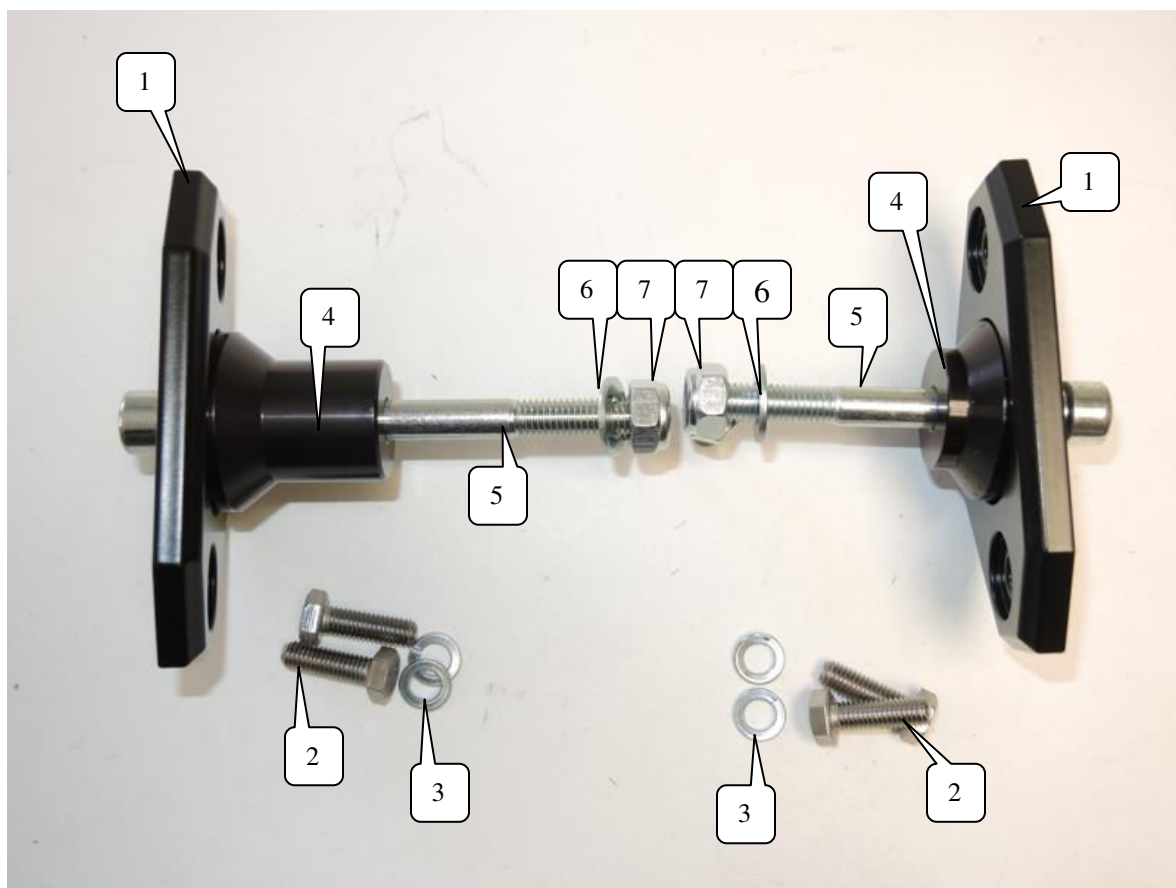

Instruction to assembly left side:

1. Take out original bolt M10 from frame.
2. On the bolt ID.5 insert dural. bracket for sld ID.1. Between the dural bracket and frame put dural. spacer ID.4 This kit mounting on the bike, from back side tighten bolt by washer ID.6 and nut ID.7.
3. On the bolts ID.2 put washers ID.3 and mounting slider.

Instruction to assembly right side:

1. Take out original bolt M10 from frame.
2. On the bolt ID.5 insert dural. bracket for sld ID.1. Between the dural bracket and frame put dural. spacer ID.4 This kit mounting on the bike, from back side tighten bolt by washer ID.6 and nut ID.7.
3. On the bolts ID.2 put washers ID.3 and mounting slider.

Use glue of all threads. Medium strong. (blue colour).

