

B8SD

BMW S 1000XR 2015-

Fitting kit left side:

ID	Description	Cat.N	Qt
1	Alu. adapter	701	1
2	Alu. spacer d=6,7mm	1105	2
3	Bolt M10x60 rear	850	1
4	Bolt M10x65 front	943	1
5	Washer M10	804	1
6	3M Tape	3M	1
7	Plastic cover	X4	2
8	Alu. cone spacer d=60mm	14	1
9	Alu. adapter for slider	537	1
10	Bolt M10x80	852	1
11	Bolt M8x25	815	2
12	Washer M8	802	2

Fitting kit right side:

ID	Description	Cat.N	Qt
1	Alu. adapter	700	1
2	Alu. spacer d=7,2mm	1107	1
3	Bolt M10x65	943	1
4	Bolt M8x30	942	1
5	Nylon cylind. d=20mm	X6	1
6	3M Tape	3M	1
7	Plastic cover	X4	1
8	Alu. cone spacer d=40mm	12	1
9	Alu. adapter for slider	537	1
10	Bolt M10x60	850	1
11	Bolt M8x25	815	2
12	Washer M8	802	2

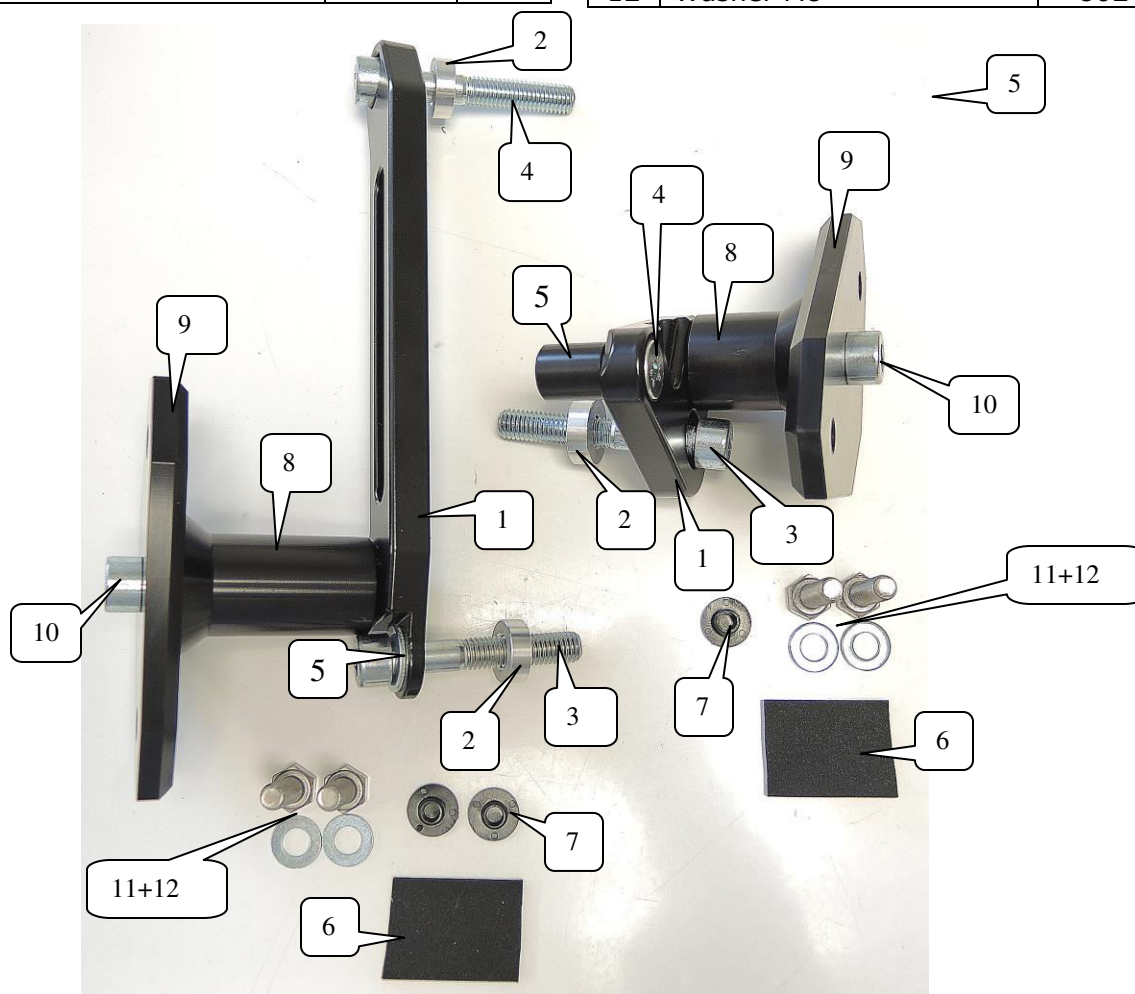



Left side instructions:

1. Remove fairing of the motorcycle.
2. Dismantle bolts M10 from the frame. Insert spacers ID.2 into the frame.
3. Stick 3M tape on the frame. Place alu. adapter ID.1 by bolts ID.3+ID5 and ID.4.
4. Place plastic cover into the bolts.
5. Put fairing back on the motorcycle.
6. Insert bolt ID.10 through the aluminum adapter ID.9. and cone spacer ID.8.
7. Tighten this kit on the adapter ID1.
8. Fit slider by bolts and washers ID.11 and ID.12.

Right side instructions:

1. Dismantle bolt M10 from the frame. Insert spacers ID.2 into the frame.
2. Place poly cylinder ID.5 from back side on the dural adapter ID.1 and tighten it by bolt ID.4. Stick 3M tape on the frame. Fix alu. adapter ID.1 using bolt ID.3.
3. Place plastic cover into bolt.
4. Insert bolt ID.10 through the aluminum adapter ID.9. and cone spacer ID.8. Tighten this kit on the adapter ID1.
5. Fix slider using bolts and washers ID.11 and ID.12.

We recommend to use the glue on all threads (medium strong).